

NOVUS Residential

SALES
LETTINGS
MANAGEMENT

HARDING COURT, HARPENDEN, AL5



A newly refurbished one-bedroom ground floor maisonette that benefits from a communal garden and garage located within walking distance of the town centre.

The accommodation comprises an open plan lounge and kitchen/breakfast room, double bedroom and a bathroom. Externally, there is a communal garden with a South facing aspect, a garage and parking.

Masefield Road is quiet residential turning which is situated within a short walk of the town centre. Harpenden Town Centre is less than a mile away and offers a wide range of boutique shops and restaurants. Harpenden mainline station provides easy access into London in less than thirty minutes.

£950.00 PCM

Un-Furnished

Available: IMMEDIATELY

0208 350 8936

rightmove 
find your happy

move@novusresidential.co.uk

 **ZPG**

PRS Property
Redress
Scheme



Council Tax - B £1,492.00 (St Albans)



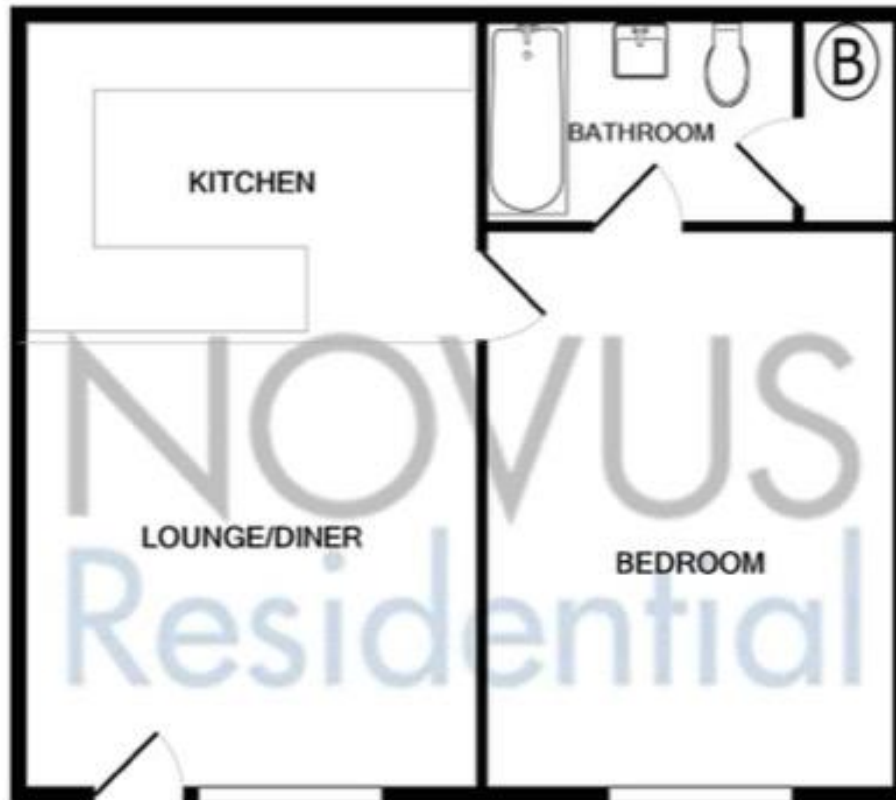

TOTAL APPROX. FLOOR AREA 410 SQ.FT. (38.1 SQ.M.)

Whilst every attempt has been made to ensure the accuracy of the floor plan contained here, measurements of doors, windows, rooms and any other items are approximate and no responsibility is taken for any error, omission, or mis-statement. This plan is for illustrative purposes only and should be used as such by any prospective purchaser. The services, systems and appliances shown have not been tested and no guarantee as to their operability or efficiency can be given

Made with Metropix ©2022

- These particulars are offered on the understanding that all negotiations are conducted through this company.
- These details and photographs have been prepared for "Novus Residential" in good faith and as a general guide, not a statement of fact.
- Neither these particulars, nor oral representations, form part of any offer or contract and their accuracy cannot be guaranteed.
- Any floor plan provided is for representation purposes only, measurements are approximate and should not be relied upon, whilst every attempt has been made to ensure their accuracy the measurements of windows, doors and rooms are approximate and should be used as such by prospective purchasers.
- We have not tested any services, systems and appliances mentioned and we cannot verify that they are in working order.
- Should you have a query or complaint about our service, please contact us at move@novusresidential.co.uk.

