

NOVUS Residential

SALES
LETTINGS
MANAGEMENT

LODGE DRIVE, PALMERS GREEN, N13



A newly refurbished first floor (top) one bedroom flat in this attractive bay fronted period conversion ideally located for the many amenities of Palmers Green. The accommodation, that extends to 560 sq ft, comprises ground floor entrance with stairs rising to first floor landing and doors leading to: large bay fronted reception room, separate fully applanced galley kitchen, double bedroom (with built in wardrobe) to rear aspect, fully tiled bathroom suite and a separate/guest WC. The property is benefits from several period features to include coving,, high ceilings, tessellated entrance hall and an ornate cast iron fire surround. Additional features include UPVC double-glazing, quality laminate wood flooring throughout and loft storage.

Lodge Drive is an attractive residential street of period properties and is closely located to Palmers Green's Triangle, the junction of Alderman's Hill and Green Lanes. Therefore, the property is very well located for the many social and leisure amenities of Palmers Green that comprise a Morrisons Supermarket, numerous independent retailers, a Farmers Market and well-regarded restaurants. Broomfield Park (a 21-hectare public park) is easily accessible and consists of playing fields, a boating lake and community orchard. Palmers Green Station (Overground) is within comfortable walking distance and provides regular commuter rail services to London's Moorgate and Kings Cross Station's.

£1,300 PCM

Un-Furnished

Available Now

0208 350 8936

move@novusresidential.co.uk

rightmove 
find your happy

ZPG

PRS Property
Redress
Scheme



Council Tax - C £1,596 (Enfield)





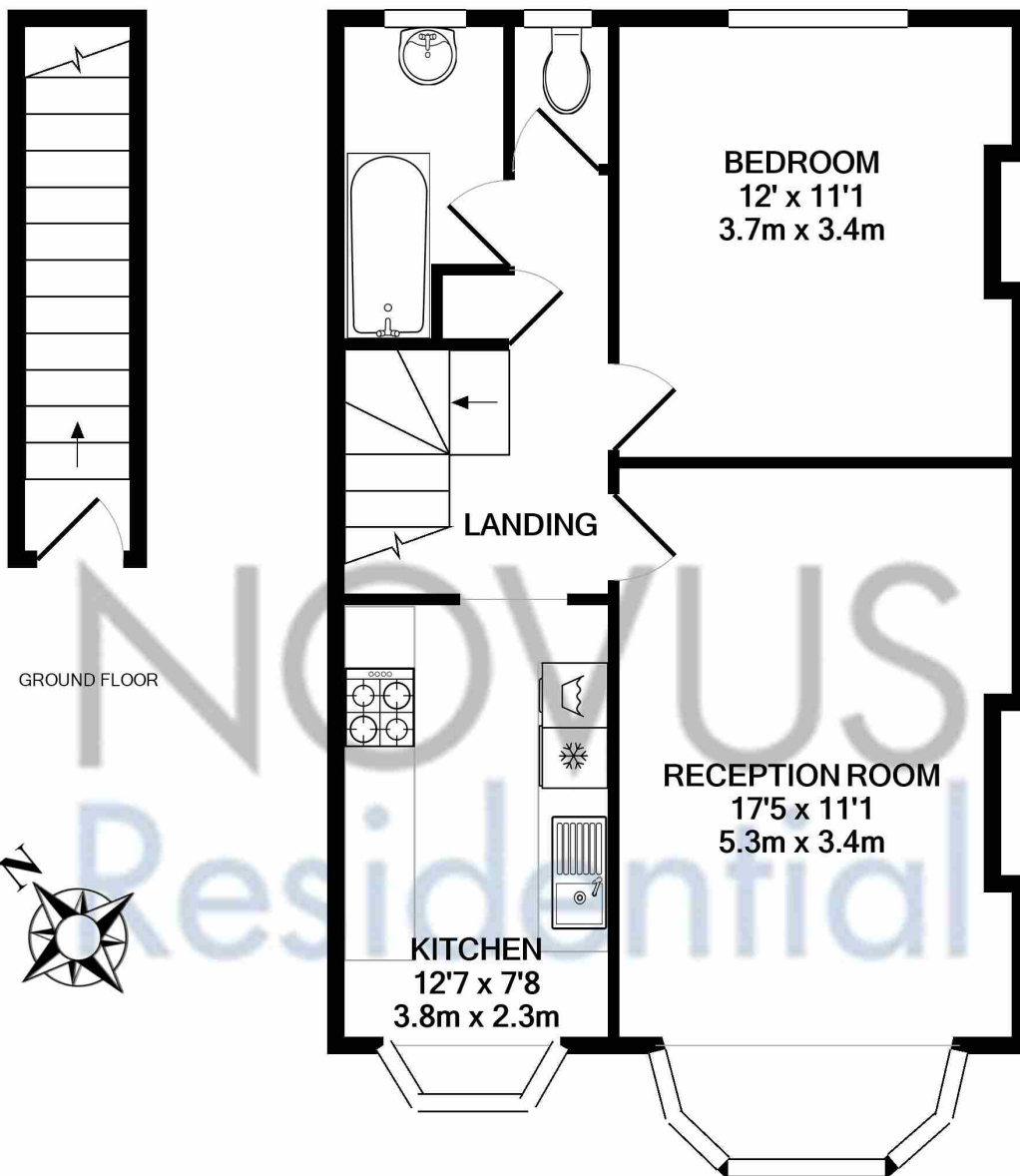

GROUND FLOOR

1ST FLOOR

TOTAL APPROX. FLOOR AREA 566 SQ.FT. (52.6 SQ.M.)

Whilst every attempt has been made to ensure the accuracy of the floor plan contained here, measurements of doors, windows, rooms and any other items are approximate and no responsibility is taken for any error, omission, or mis-statement. This plan is for illustrative purposes only and should be used as such by any prospective purchaser. The services, systems and appliances shown have not been tested and no guarantee as to their operability or efficiency can be given

Made with Metropix ©2021

- These particulars are offered on the understanding that all negotiations are conducted through this company.
- These details and photographs have been prepared for "Novus Residential" in good faith and as a general guide, not a statement of fact.
- Neither these particulars, nor oral representations, form part of any offer or contract and their accuracy cannot be guaranteed.
- Any floor plan provided is for representation purposes only, measurements are approximate and should not be relied upon, whilst every attempt has been made to ensure their accuracy the measurements of windows, doors and rooms are approximate and should be used as such by prospective purchasers.
- We have not tested any services, systems and appliances mentioned and we cannot verify that they are in working order.
- Should you have a query or complaint about our service, please contact us at move@novusresidential.co.uk.